

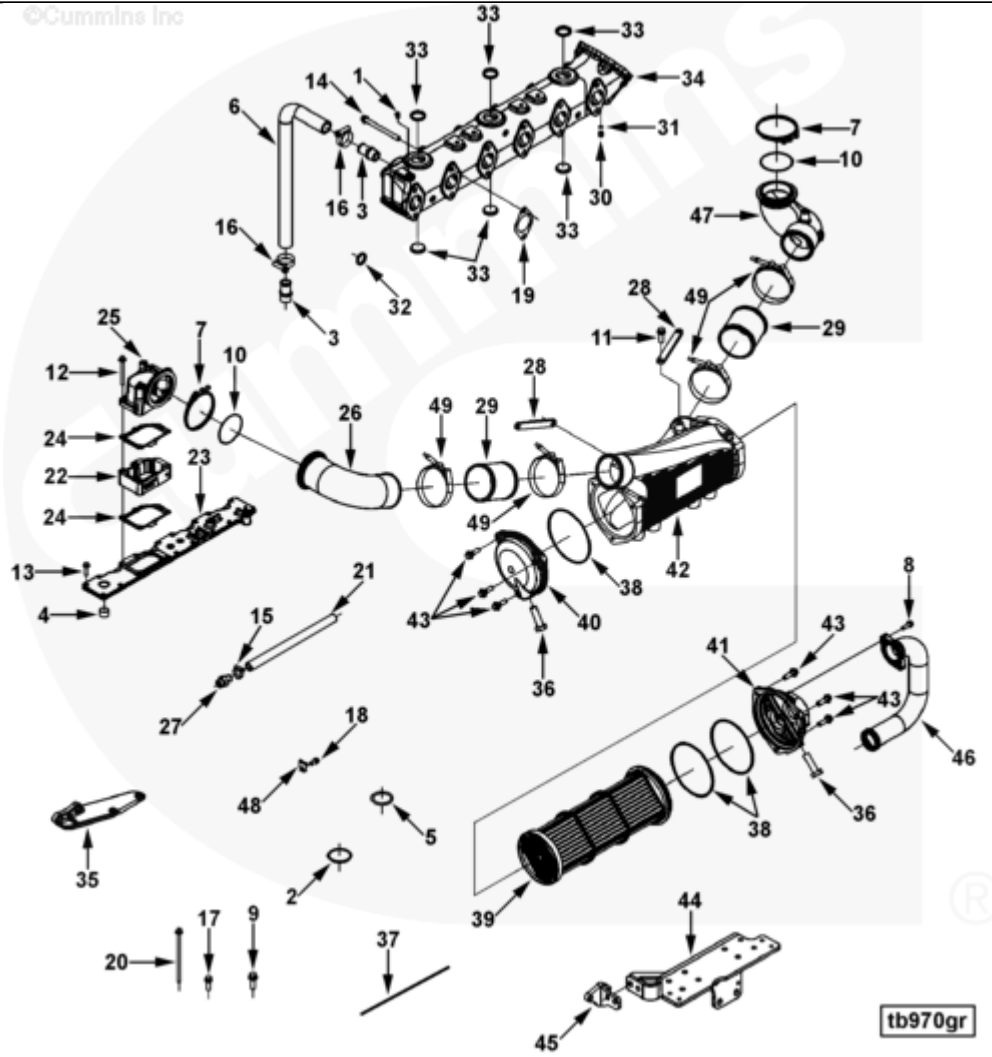

## Parts Catalog - Option Detail

Electronic Parts Catalog - Option Detail				
Option	Group	Graphic	Film Card	Date
TB9882-14	10.06.1	tb970gr	Z	30-JUL-04
<b>Engines</b>	6C8.3, C GAS PLUS CM556, G8.3, G8.3 CM558, GTA8.3 CM558, ISC CM2150, ISC CM554, ISC CM850, ISC8.3 CM2250, ISC8.3 G CM2180 C101, ISL CM2150, ISL CM554, ISL CM850, ISL G CM2180, ISL8.9 CM2150 L110, ISL8.9 CM2880 L112, ISL9 CM2150 SN, ISL9 CM2250, ISL9 CM2350 L101, ISL9 CM2350 L111, ISLE4 CM850, L GAS PLUS CM556, L8.9, L8.9 L121, L8.9G CMOH2.0 L125B, L9 CM2350 L116B, L9 CM2350 L119B, L9 CM2350 L120C, L9 CM2350 L123B, L9.3 L105, L9.5 L117, L9N CM2380 L124B, QSC8.3 CM2250, QSC8.3 CM2880 C102, QSC8.3 CM554, QSC8.3 CM850(CM2850), QSL9 CM2250, QSL9 CM2250 L115, QSL9 CM2350 L102, QSL9 CM2350 L107, QSL9 CM2350 L118, QSL9 CM2350 L122, QSL9 CM554, QSL9 CM850(CM2850), QSL9 G CM558, QSL9 M CM2250 L106, QSL9.3 CM2880 L113			



SMALL | MEDIUM | LARGE

Cart	Ref No	Part Number	Part Description	Required	Remarks
View My Cart					

		TB9882-14	Turbocharger Arrangement		MR - ARRANGEMENT, TURBOCHARGE...(More)
					Design Phase: Pegasus Alpha
					Engine Family: C Series
					Engine Cylinders: 6
					Engine Aspiration: Sea Water
					Aftercooled
					Exhaust Outlet Location:
					RMSO
					- From Engine Centerline
					(mm): -250
					- From Crank Centerline
					(mm): 496
					- From Front Face of Block
					(mm): -1022
					Exhaust Outlet Flange Type:
					4 Bolt
					Exhaust Outlet Diameter
					(mm): 89
					Turbo Model: HX55W
					Turbo Flange Angle from
					Vertical (deg): 40
					CPR Outlet Flange Type: Half
					Marmon
					CPR Outlet Diameter (mm):
					76.2
					CPR Outlet on Engine Location
					(deg): 0 (Horizontal)
					Manifold Type: Wet
					Wastegate Capsule Spigot
					Location:

					- From Front Face of Block
					(mm): 55
					- From Crank Centerline
					(mm): 573
					- From Front Face of Block
					(mm): -874
					Base Turbo ID 17: 4037489
					Unique Characteristics: For
					Use With SAE #2 Flywheel
					Housing
<input type="checkbox"/>	1	<a href="#">S 949 B</a>	Pipe Plug	1	1/8 NPT
<input type="checkbox"/>	2	<a href="#">145582</a>	O-Ring Seal	1	
<input type="checkbox"/>	3	<a href="#">215921</a>	Plain Hose Coupling	2	3/4 NPTF x 1 in.
<input type="checkbox"/>	4	<a href="#">3008469</a>	Pipe Plug	1	3/4 NPT
<input type="checkbox"/>	5	<a href="#">3028291</a>	O-Ring Seal	1	
<input type="checkbox"/>	6	<a href="#">3031367</a>	Plain Hose	1	
<input type="checkbox"/>	7	<a href="#">3067979</a>	V Band Clamp	2	
<input type="checkbox"/>	8	<a href="#">3093730</a>	Hexagon Flange Head Cap Screw	14	M8 x 1.25 x 25
<input type="checkbox"/>	9	<a href="#">3093939</a>	Hexagon Flange Head Cap Screw	4	M12 x 1.75 x 35
<input type="checkbox"/>	10	<a href="#">3682177</a>	O-Ring Seal	2	
<input type="checkbox"/>	11	<a href="#">3900227</a>	Hexagon Head Cap Screw	4	M8 X 1.25 X 22.
<input type="checkbox"/>	12	<a href="#">3902112</a>	Hexagon Flange Head Cap Screw	2	M8 x 1.25 x 80
<input type="checkbox"/>	13	<a href="#">3902114</a>	Hexagon Flange Head Cap Screw	14	M8 X 1.25 X 30.
<input type="checkbox"/>	14	<a href="#">3916518</a>	Hexagon Flange Head Cap Screw	12	M10 X 1.50 X 125.
<input type="checkbox"/>	15	<a href="#">3922841</a>	Hose Clamp	1	
<input type="checkbox"/>	16	<a href="#">3922843</a>	Hose Clamp	2	
<input type="checkbox"/>	17	<a href="#">3925344</a>	Hexagon Flange Head Cap Screw	4	M10 X 1.50 X 30.

<input type="checkbox"/>	18	3925883	Hexagon Flange Head Cap Screw	2	M8 X 1.25 X 16
	19	3937479	Exhaust Manifold Gasket	6	
<input type="checkbox"/>	20	3943682	Hexagon Flange Head Cap Screw	2	M8 x 1.25 x 160
<input type="checkbox"/>	21	3944714	Plain Hose	1	
<input type="checkbox"/>	22	3965886	Mounting Spacer	1	
<input type="checkbox"/>	23	3967069	Intake Manifold Cover	1	
<input type="checkbox"/>	24	3967891	Connection Gasket	2	
<input type="checkbox"/>	25	3968371	Air Intake Connection	1	
<input type="checkbox"/>	26	3970795	Air Transfer Connection	1	
<input type="checkbox"/>	27	3970799	Check Valve	1	
<input type="checkbox"/>	28	3970817	Retaining Brace Bracket	2	
<input type="checkbox"/>	29	3971365	Plain Hose	2	
<input type="checkbox"/>		3971505	Exhaust Manifold	1	
<input type="checkbox"/>		3678923	Threaded Plug	1	M10 X 1.00 X 13.5
<input type="checkbox"/>	30	3678924	Threaded Plug	1	M10 X 1.00 X 13.5
<input type="checkbox"/>	31	3678925	O-Ring Seal	1	M10.
		3971430	Exhaust Manifold	1	Service as 3971505
<input type="checkbox"/>	32	3007636	Expansion Plug	2	
<input type="checkbox"/>	33	3908092	Expansion Plug	6	
	34	3971431	Exhaust Manifold	1	Service as 3971505
<input type="checkbox"/>	35	3972053	Aftercooler Support	1	
<input type="checkbox"/>		3974306	Aftercooler	1	
<input type="checkbox"/>	36	68241	Zinc Electrode Plug	2	1/2 NPTF x 2 in.
<input type="checkbox"/>	37	3966833	Aftercooler Core Seal	4	
	38	3971678	O-Ring Seal	3	
	39	3974302	Aftercooler Core	1	
<input type="checkbox"/>	40	3974303	Water Transfer Connection	1	
<input type="checkbox"/>	41	3974304	Water Transfer Connection	1	
	42	3974305	Aftercooler Housing	1	

<input type="checkbox"/>	43	<a href="#">4058183</a>	Hexagon Flange Head Cap Screw	6	M10 x 1.50 x 35
<input type="checkbox"/>	44	<a href="#">3976962</a>	Aftercooler Bracket	1	
<input type="checkbox"/>	45	<a href="#">3976967</a>	Aftercooler Bracket	1	
<input type="checkbox"/>	46	<a href="#">3978101</a>	Sea Water Pump Tube	1	
<input type="checkbox"/>	47	<a href="#">3978967</a>	Air Transfer Connection	1	
<input type="checkbox"/>	48	<a href="#">4003347</a>	Tube Clamp	2	
<input type="checkbox"/>	49	<a href="#">4086588</a>	T-Bolt Clamp	4	3 3/4 in.
				A/R	
<input type="checkbox"/>		<a href="#">3972366</a>	Raw Water Pump-Minor Kit	A/R	
<input type="checkbox"/>		<a href="#">3972367</a>	Raw Water Pump-Intermediate Kit	A/R	
<input type="checkbox"/>		<a href="#">3972368</a>	Raw Water Pump-Major Kit	A/R	